

FLEXSAFE™

Product technical data

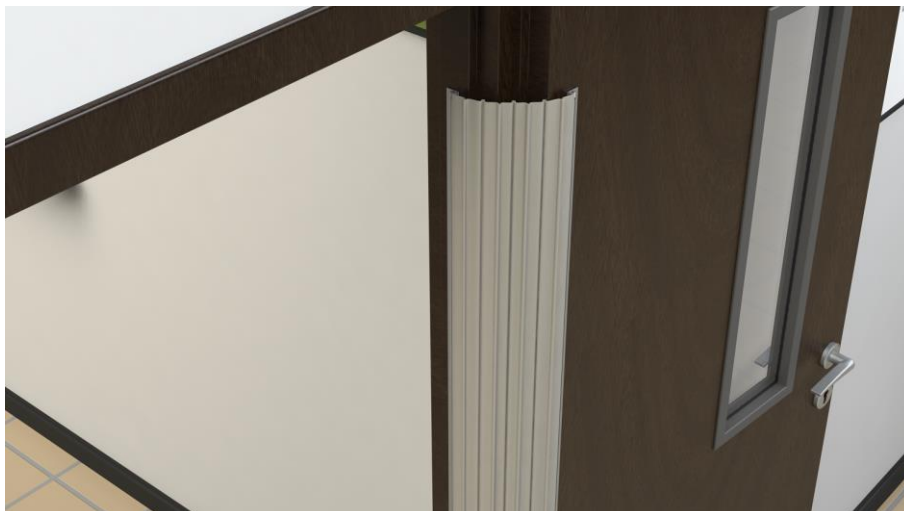

Product description

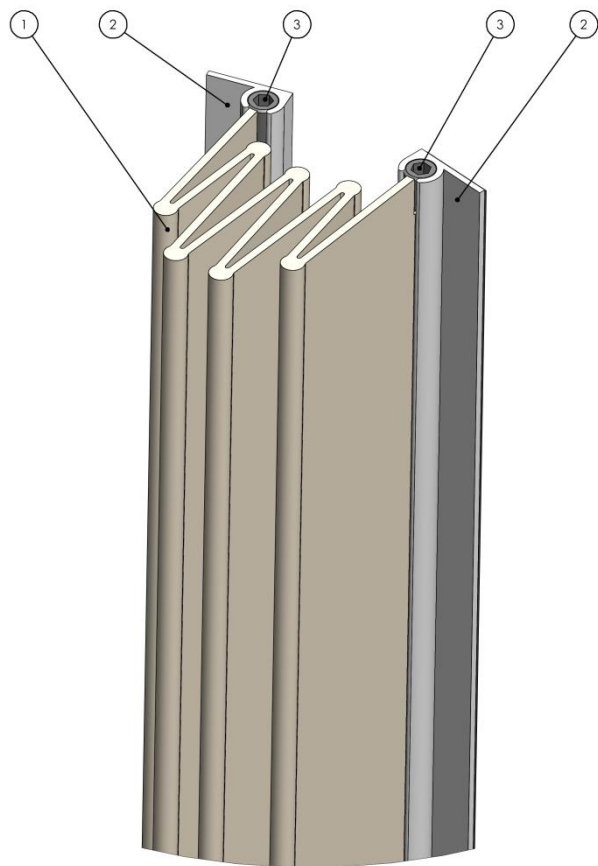

Parts list:

1. PVC protector
2. Aluminum profile
3. Set screw

The height of the FLEXSAFE™ is 70".

Configurations:

FLEXSAFE™ V1 – For use on regular thickness doors, protects from inner frame side.

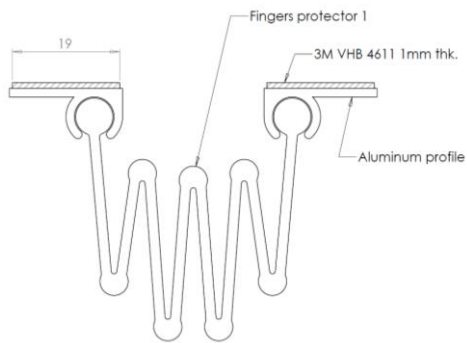

FLEXSAFE™ V2 – For use on extra thick doors, protects from inner frame side.

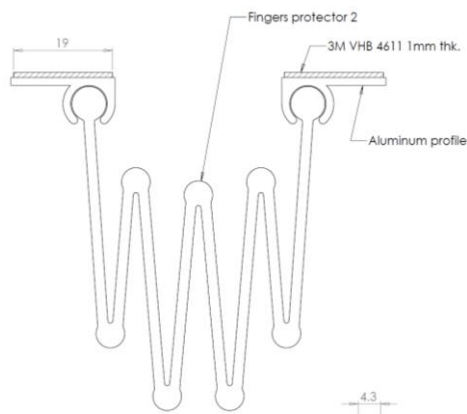

FLEXSAFE™ V3 – For use on outer frame side (hinges side).

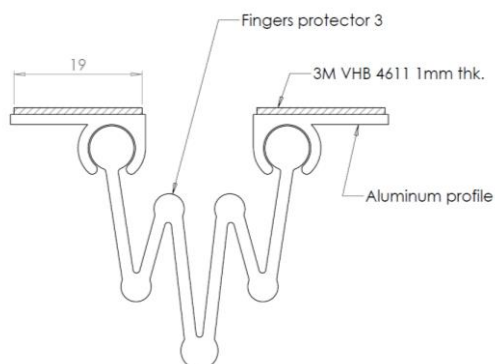

Door safety products

Installation instructions

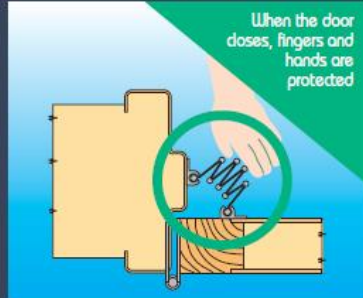

Installation

IMPORTANT: Please carefully read the following instructions prior to installing **FLEXAFE™**

1. Clean and dry door and doorframe surface (use alcohol or any household cleanser) prior to attaching **FLEXAFE™** to the surface.



2. Mark the doorframe at 70 inches from floor level.



3. Close the door. Place the enclosed angle separator at the marked 70 inch height. Mark both the door and the doorframe, at either end of the angle separator (1.5 inches from connection point). To insure width consistency along the doorframe and door, we recommend that you repeat this step in 4 or 5 places going down along the doorframe and door.



4. Open the door. Going from top to bottom, gently peel the paper from the adhesive side of the right hand aluminum rod as you attach the rod to the doorframe at the height and width marked in Steps 2 and 3. Make sure the aluminum rod is connected securely to the doorframe.

5. Repeat step 4 with the left-hand rod and connect it to the door.

6. When the rods are attached use a simple roller or any other pressure tool to firmly fasten the rods to the door and doorframe surface.



Important!

1. The special glue used in **FLEXAFE™** achieves maximum effectiveness 48 hours after it has been applied. If possible, limit the door opening angle to no more than 90 degrees over the first 2 days.
2. You may have noticed the 7 holes on the aluminum rods. These are designed to allow you to change **FLEXAFE™** location after its initial installation. You may fit screws through these holes to reattach **FLEXAFE™** to another entryway.
3. **FLEXAFE™** is safe for all doors, including painted ones. Its effectiveness is not compromised by any surface treatment applied to the door or doorframe. When used on wallpaper, **FLEXAFE™** may require additional reinforcement by applying screws through the screw holes provided.